



# MDC (M12) Series Receptacles

4 & 5 Conductor MDC Series Receptacles



PCB Mount Male Receptacles | 250 Volt, 4 amps | IP67 Rating



# of Poles	Male Faceview	Rating	Style	Straight	Right Angle
4	<p>M12 x 1</p>	250V 4A	PCB Mount	MDC-4MR-PCB	MDC-4MR-PCB-R
			PCB Mount w/ Ground Tab	MDCM-4MR-PCB	MDCM-4MR-PCB-R
5	<p>M12 x 1</p>	250V 4A	PCB Mount	MDC-5MR-PCB	MDC-5MR-PCB-R
			PCB Mount w/ Ground Tab	MDCM-5MR-PCB	MDCM-5MR-PCB-R

### Male Straight

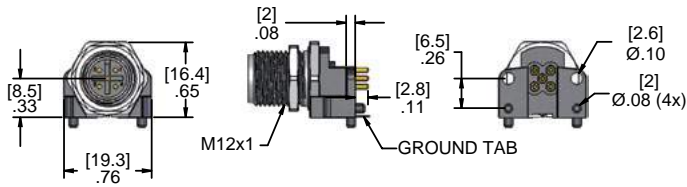

### Male Right Angle

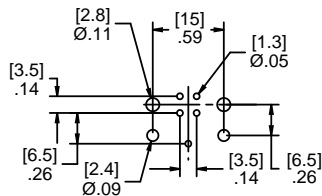
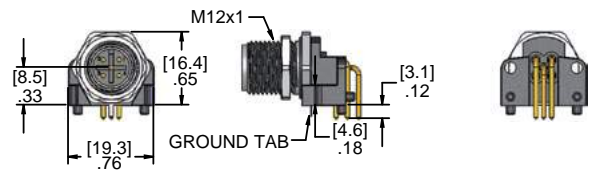

4 Pole Female Straight Layout

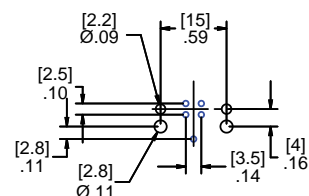
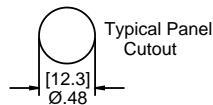

4 Pole Female Right Angle Layout

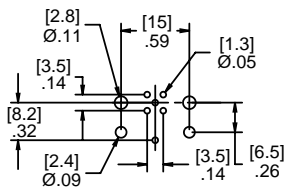

5 Pole Female Straight Layout

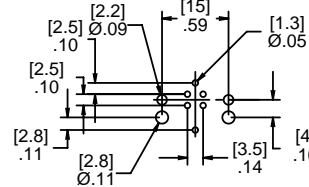

5 Pole Female Right Angle Layout

### Specifications:

Body: Polyamide  
 Contacts: Copper Alloy with Gold Plating  
 Shell: Nickel Plated Brass

O-Ring: NBR  
 Jam Nut: Nickel Plated Brass  
 Temperature: -40°C to 105°C (-40°F to +221°F)

H

Micro-DC (M12) Series Receptacles